

Xive®

# Xive® S: RepairSet step-by-step

Remove fractured threaded components /  
Abutment screws from Xive® S D 3.0 / D 3.4 / D 3.8 - 5.5

Dentsply  
Sirona  
Implants

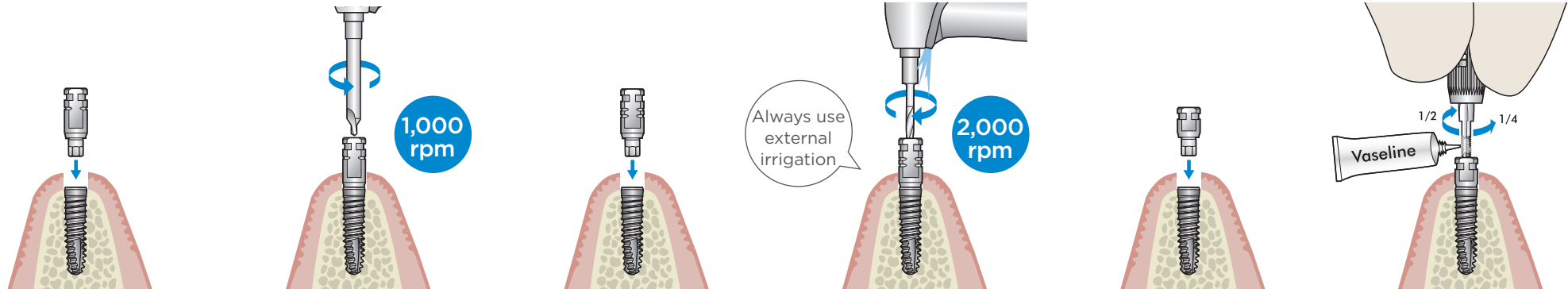

D 3.0

**1 |** Seat the guide sleeve F/1 (1groove) onto the implant and set the surgical unit to **reverse**.

Interrupt drilling repeatedly to rinse and suction out debris. Replace dull drills immediately.

**2 |** Insert the center drill into the guide sleeve and run it in **reverse** with moderate pressure at approximately 1,000 rpm. Remove the guide sleeve.

**3 |** Seat the guide sleeve F/2 (2 grooves) onto the implant and set the surgical unit to **forward**.

**4 |** Insert twist drill D 1.1 into the guide sleeve. Drill out the fragment with light pressure at approximately 2,000 rpm until the drill shaft reaches the top of the guide sleeve. Interrupt repeatedly to rinse and suction out debris. Remove the guide sleeve.

**5 |** Seat the guide sleeve F/3 (0 grooves) onto the implant.

**6 |** Lubricate the tap M 1.4 with Vaseline. Rotate the tap ½ of a revolution clockwise (**forward**) and a ¼ of a revolution counter-clockwise (**reverse**) by hand. Continue until the shaft of the tap reaches the top of the guide sleeve.

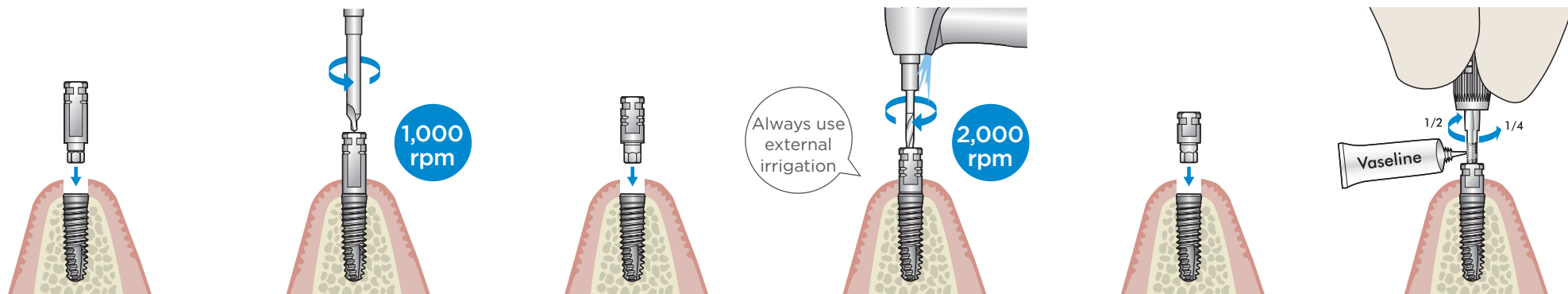

D 3.4

**1 |** Seat the guide sleeve F/1 (1groove) onto the implant and set the surgical unit to **reverse**.

Interrupt drilling repeatedly to rinse and suction out debris. Replace dull drills immediately.

**2 |** Insert the center drill into the guide sleeve and run it in **reverse** with moderate pressure at approximately 1,000 rpm. Remove the guide sleeve.

**3 |** Seat the guide sleeve F/2 (2 grooves) onto the implant and set the surgical unit to **forward**.

**4 |** Insert twist drill D 1.3 into the guide sleeve. Drill out the fragment with light pressure at approximately 2,000 rpm until the drill shaft reaches the top of the guide sleeve. Interrupt repeatedly to rinse and suction out debris. Remove the guide sleeve.

**5 |** Seat the guide sleeve F/3 (0 grooves) onto the implant.

**6 |** Lubricate the tap M 1.6 with Vaseline. Rotate the tap ½ of a revolution clockwise (**forward**) and a ¼ of a revolution counter-clockwise (**reverse**) by hand. Continue until the shaft of the tap reaches the top of the guide sleeve.

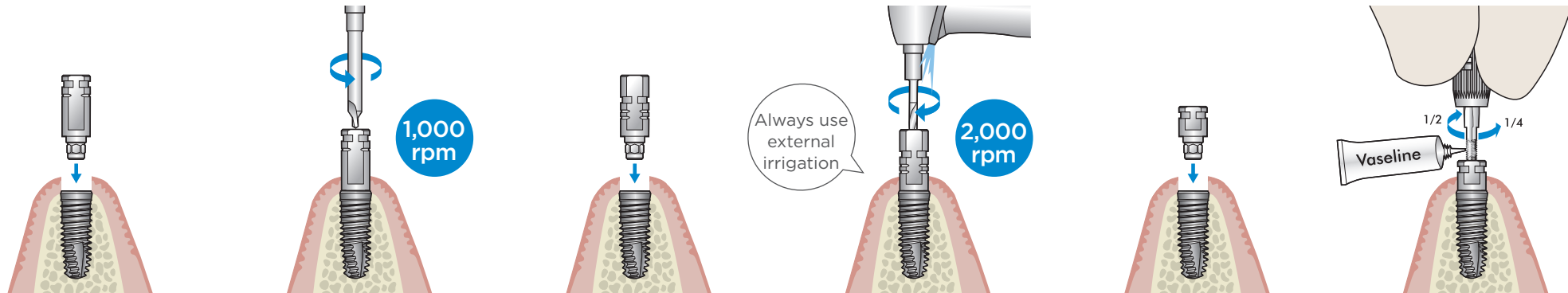

**1 |** Seat the guide sleeve F/1 (1 groove) onto the implant and set the surgical unit to **reverse**.

Interrupt drilling repeatedly to rinse and suction out debris. Replace dull drills immediately.

**2 |** Insert the center drill into the guide sleeve and run it in **reverse** with moderate pressure at approximately 1,000 rpm. Remove the guide sleeve.

**3 |** Seat the guide sleeve F/2 (2 grooves) onto the implant and set the surgical unit to **forward**.

**4 |** Insert twist drill D 1.3 into the guide sleeve. Drill out the fragment with light pressure at approximately 2,000 rpm until the drill shaft reaches the top of the guide sleeve. Interrupt repeatedly to rinse and suction out debris. Remove the guide sleeve.

**5 |** Seat the guide sleeve F/3 (0 grooves) onto the implant.

**6 |** Lubricate the tap M 1.6 with Vaseline. Rotate the tap ½ of a revolution clockwise (**forward**) and a ¼ of a revolution counter-clockwise (**reverse**) by hand. Continue until the shaft of the tap reaches the top of the guide sleeve.



### Guide Sleeves

(Respectively suitable for either D 3.0, D 3.4 or D 3.8 - 5.5 implants)

F/1  
1 groove

F/2  
2 grooves

F/3  
0 grooves

Center Drill

### Drills

Twist Drill D 1.1 or  
Twist Drill D 1.3 (3pcs.)

### Taps

Thread Tap M 1.4 or  
Thread Tap M 1.6

www.dentsplysirona.com